

Installation can be done by merely lowering the pump into a discharge column

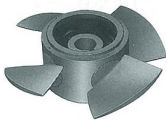

Impeller of SSP

Special Features:

- It is easy to install the pump into a discharge column where the force of gravity and the pumping pressure keeps it seated firmly.
- Since it is a submersible type, no priming water is necessary. It is an advantage in emergency or automatic operation.
- It saves the work time for maintenance and inspection as removal and reinstallation can be quickly performed.
- The pump takes less aboveground space than end-suction centrifugal pumps, which reduces the construction and facility cost.
- It is possible to select the best installation method from among several types of discharge columns: steel pipe, cast iron pipe, and concrete casing, etc.
- It is compact but exhibits high efficiency and performance.
- The pumps are available with the discharge diameter ranging from 300mm to 1500mm.

Applications:

- Pumping wastewater and stormwater in sewerage system
- Land drainage and irrigation
- Emergency floodwater drainage
- Draining or transferring large volumes of water

Major Components & Specifications:

Discharge Bore		mm	300	400	500	600	700	800	900	1000	1200	1350	1500
Pumping Fluid	Type of Fluid	Stormwater, river water, wastewater											
	Fluid Temperature	0 to 40°C											
Pump	Structure	Impeller	Axial Flow Type										
		Shaft Seal	Double Mechanical Seal										
		Bearing	Ball Bearing or Roller Bearing										
	Materials	Impeller	Bronze Casting										
		Guide Casing	Gray Cast Iron										
		Suction Casing	Gray Cast Iron										
	Shaft Seal	SiC											
Motor	Type	Dry Type Submersible Induction Motor											
	Insulation	Class E or Class F											
	Phase	Three-Phase											
	Built-in Protection Devices	Circle Thermal Protector (7.5kW and below)											
		Miniature Protector (11kW and over)											
		Leakage Sensor (22kW and over)											
Lubricant	Turbine Oil ISO VG32												
Materials	Motor Frame	Gray Cast Iron											
	Shaft	420 Stainless Steel											
	Cable	Chloroprene Rubber or Polychloroprene Rubber Sheathed											

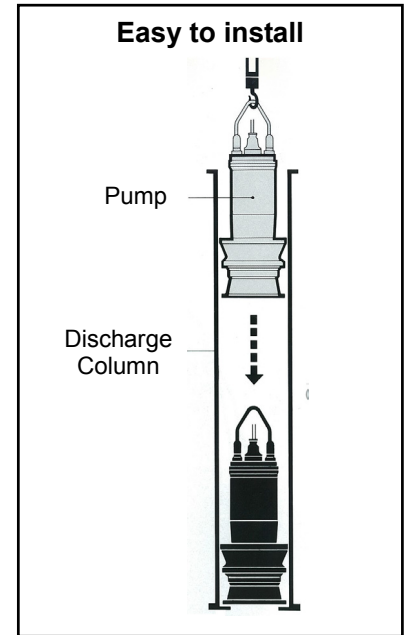

Installation Examples:

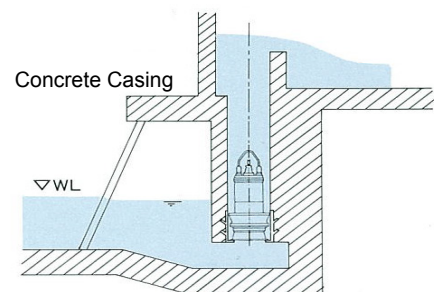
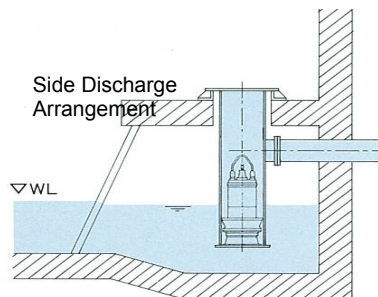
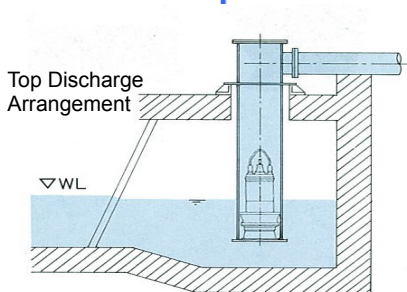

Архангельск (8182)63-90-72
 Астана (7172)727-132
 Астрахань (8512)99-46-04
 Барнаул (3852)73-04-60
 Белгород (4722)40-23-64
 Брянск (4832)59-03-52
 Владивосток (423)249-28-31
 Волгоград (844)278-03-48
 Вологда (8172)26-41-59
 Воронеж (473)204-51-73
 Екатеринбург (343)384-55-89
 Иваново (4932)77-34-06

Ижевск (3412)26-03-58
 Иркутск (395)279-98-46
 Казань (843)206-01-48
 Калининград (4012)72-03-81
 Калуга (4842)92-23-67
 Кемерово (3842)65-04-62
 Киров (8332)68-02-04
 Краснодар (861)203-40-90
 Красноярск (391)204-63-61
 Курск (4712)77-13-04
 Липецк (4742)52-20-81
 Киргизия (996)312-96-47

Магнитогорск (3519)55-03-13
 Москва (495)268-04-70
 Мурманск (8152)59-64-93
 Набережные Челны (8552)20-53-41
 Нижний Новгород (831)429-08-12
 Новокузнецк (3843)20-46-81
 Новосибирск (383)227-86-73
 Омск (3812)21-46-40
 Орел (4862)44-53-42
 Оренбург (3532)37-68-04
 Пенза (8412)22-31-16
 Казахстан (772)734-952-31

Пермь (342)205-81-47
 Ростов-на-Дону (863)308-18-15
 Рязань (4912)46-61-64
 Самара (846)206-03-16
 Санкт-Петербург (812)309-46-40
 Саратов (845)249-38-78
 Севастополь (8692)22-31-93
 Симферополь (3652)67-13-56
 Смоленск (4812)29-41-54
 Сочи (862)225-72-31
 Ставрополь (8652)20-65-13
 Таджикистан (992)427-82-92-69

Сургут (3462)77-98-35
 Тверь (4822)63-31-35
 Томск (3822)98-41-53
 Тула (4872)74-02-29
 Тюмень (3452)66-21-18
 Ульяновск (8422)24-23-59
 Уфа (347)229-48-12
 Хабаровск (4212)92-98-04
 Челябинск (351)202-03-61
 Череповец (8202)49-02-64
 Ярославль (4852)69-52-93

Performance Curves:

50Hz

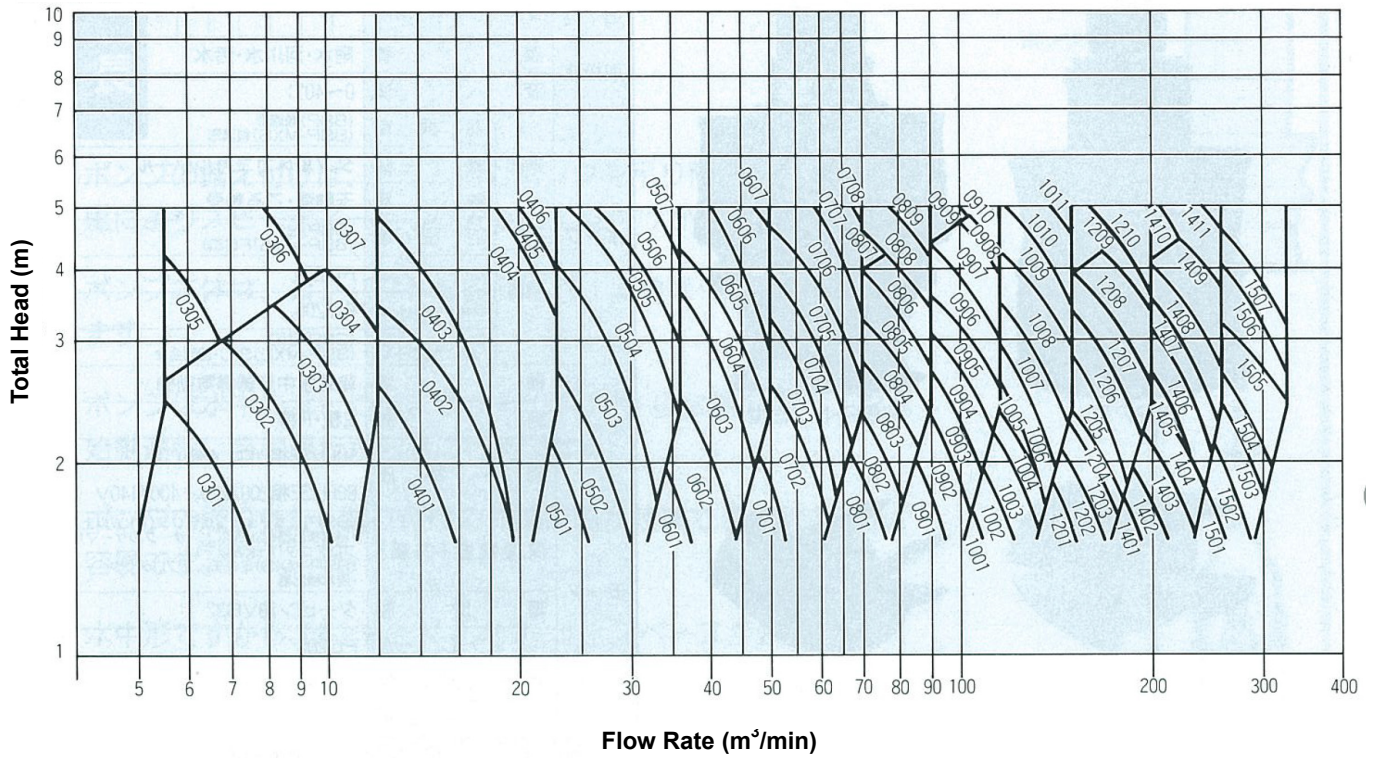

60Hz

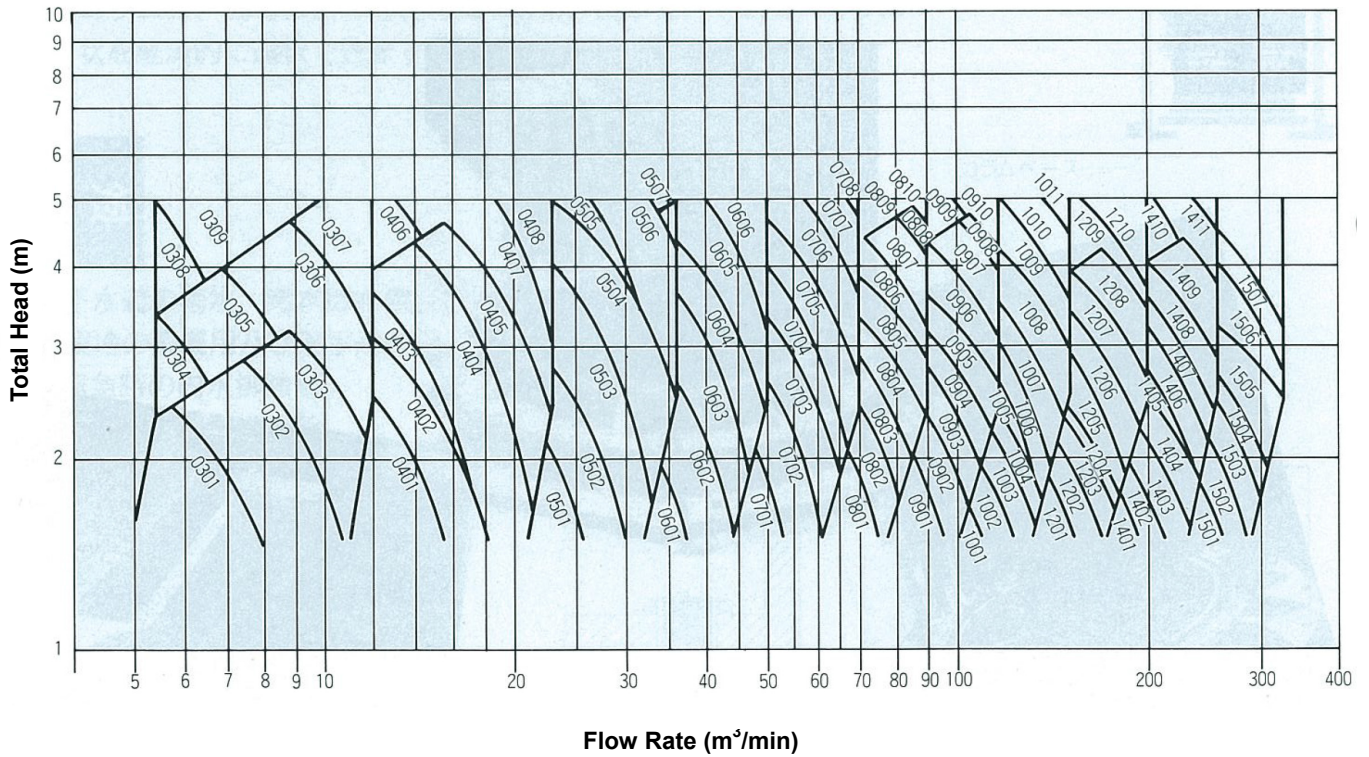

Specifications:

50Hz

Models	No.	Motor Output X No. of Poles	Speed	A (mm)	φ B	Mass (kg)
SSP-300 GS	0301	3.7× 6	SS1000	1200	490	550
	0302	5.5× 6	SS1000	1200	490	550
	0303	7.5× 6	SS1000	1200	490	600
	0304	11 × 6	SS1000	1200	490	600
	0305	7.5× 4	SS1500	1200	490	550
	0306	11 × 4	SS1500	1200	490	600
	0307	15 × 4	SS1500	1200	490	600
SSP-400 GS	0401	7.5× 8	SS 750	1350	560	750
	0402	11 × 8	SS 750	1470	560	800
	0403	15 × 6	SS1000	1350	560	750
	0404	22 × 6	SS1000	1470	560	800
	0405	30 × 6	SS1000	1500	560	1200
	0406	30 × 4	SS1500	1500	560	1100
SSP-500 GS	0501	11 ×10	SS 600	1550	660	950
	0502	15 ×10	SS 600	1600	660	1350
	0503	22 × 8	SS 750	1600	660	1350
	0504	30 × 8	SS 750	1600	660	1450
	0505	37 × 8	SS 750	1950	660	1700
	0506	37 × 6	SS1000	1600	650	1450
	0507	45 × 6	SS1000	1950	660	1700
SSP-600 GS	0601	15 ×12	SS 500	1650	760	1500
	0602	22 ×12	SS 500	2000	760	1800
	0603	30 ×10	SS 600	2000	760	1800
	0604	37 ×10	SS 600	2300	760	2400
	0605	45 × 8	SS 750	2300	760	2400
	0606	55 × 8	SS 750	2300	760	2500
	0607	65 × 8	SS 750	2300	760	2600
SSP-700 GS	0701	22 ×14	SS 428	2050	860	2100
	0702	30 ×14	SS 428	2350	850	2600
	0703	37 ×12	SS 500	2350	860	2600
	0704	45 ×12	SS 500	2350	860	2600
	0705	55 ×12	SS 500	2350	860	2700
	0706	65 ×10	SS 600	2350	860	2700
	0707	75 ×10	SS 600	2350	860	2800
	0708	90 ×10	SS 600	2350	860	2800
SSP-800 GS	0801	30 × G	SS 325	2250	960	2000
	0802	37 × G	SS 325	2350	960	2100
	0803	45 × G	SS 325	2350	960	2200
	0804	55 × G	SS 325	2350	960	2200
	0805	65 ×16	SS 375	3100	960	3700
	0806	75 ×16	SS 375	3100	960	3800
	0807	75 ×14	SS 428	2450	960	2900
	0808	90 ×14	SS 428	3100	960	3800
	0809	110 ×14	SS 428	3100	960	3800

Models	No.	Motor Output X No. of Poles	Speed	A (mm)	φ B	Mass (kg)
SSP-900 GS	0901	37×G	300	2450	1060	2500
	0902	45×G	300	2450	1060	2600
	0903	55×G	300	2450	1060	2600
	0904	65×G	300	2700	1060	2900
	0905	75×G	300	2700	1060	2900
	0906	90×G	350	3100	1060	3200
	0907	110×G	350	3100	1060	3300
	0908	132×G	350	3300	1060	3400
	0909	110×G	400	3100	1060	3300
	0910	132×G	400	3300	1060	3400
SSP-1000 GS	1001	37×G	250	2500	1160	2800
	1002	45×G	250	2500	1160	2900
	1003	55×G	250	2500	1160	3000
	1004	65×G	250	2800	1160	3200
	1005	65×G	300	2800	1160	3200
	1006	75×G	300	2800	1160	3300
	1007	90×G	300	3100	1160	3600
	1008	110×G	300	3300	1160	3800
	1009	132×G	350	3300	1160	3900
	1010	150×G	350	3300	1160	3900
	1011	175×G	350	3300	1160	4000
SSP-1200 GS	1201	55×G	200	2800	1350	4100
	1202	65×G	200	3300	1350	4700
	1203	75×G	200	3300	1350	4700
	1204	90×G	200	3300	1350	4800
	1205	90×G	250	3300	1350	4800
	1206	110×G	250	3300	1350	4900
	1207	132×G	250	3300	1350	4900
	1208	175×G	250	3550	1350	5000
	1209	175×G	300	3400	1350	5000
	1210	220×G	300	3550	1350	5200
SSP-1350 GS	1401	65×G	175	3500	1500	5500
	1402	75×G	175	3500	1500	5500
	1403	90×G	175	3500	1500	5600
	1404	110×G	175	3500	1500	5600
	1405	110×G	225	3500	1500	5700
	1406	132×G	225	3600	1500	5800
	1407	150×G	225	3500	1500	5800
	1408	175×G	225	3600	1500	5900
	1409	220×G	225	3600	1500	6000
	1410	220×G	275	3600	1500	6000
	1411	250×G	275	4100	1500	6500
SSP-1500 GS	1501	90×G	175	3600	1650	6500
	1502	110×G	175	3800	1650	6800
	1503	132×G	175	3800	1650	6800
	1504	150×G	175	3800	1650	6800
	1505	175×G	175	3800	1650	6900
	1506	220×G	225	3800	1650	6900
	1507	250×G	225	3800	1650	7000

G: with Gears SS: Synchronous Speed

Note:

The symbols A and B in the specifications show the dimensions indicated in the right-hand figure.

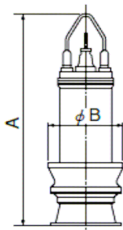

Specifications:

60Hz

Models	No.	Motor Output x No. of Poles	Speed	A (mm)	φ B	Mass (kg)
SSP-300 GS	0301	3.7× 8	SS 900	1200	490	550
	0302	5.5× 8	SS 900	1200	490	600
	0303	7.5× 8	SS 900	1200	490	650
	0304	5.5× 6	SS1200	1200	490	550
	0305	7.5× 6	SS1200	1200	490	600
	0306	11 × 6	SS1200	1200	490	600
	0307	15 × 6	SS1200	1250	490	650
	0308	7.5× 4	SS1800	1200	490	600
	0309	11 × 4	SS1800	1200	490	600
SSP-400 GS	0401	7.5×10	SS 720	1470	560	800
	0402	11 ×10	SS 720	1470	560	800
	0403	11 × 8	SS 900	1470	560	800
	0404	15 × 8	SS 900	1470	560	800
	0405	22 × 8	SS 900	1500	560	1200
	0406	15 × 6	SS1200	1350	560	750
	0407	22 × 6	SS1200	1470	560	800
	0408	30 × 6	SS1200	1500	560	1200
SSP-500 GS	0501	11 ×12	SS 600	1600	660	1350
	0502	15 ×12	SS 600	1600	660	1350
	0503	22 ×10	SS 720	1600	660	1350
	0504	30 ×10	SS 720	1950	650	1700
	0505	30 × 8	SS 900	1600	660	1450
	0506	37 × 8	SS 900	1950	660	1700
	0507	45 × 8	SS 900	2300	660	2000
SSP-600 GS	0601	15 ×14	SS 514	2000	760	1800
	0602	22 ×14	SS 514	2000	760	1900
	0603	30 ×12	SS 600	2000	760	1900
	0604	37 ×12	SS 600	2300	760	2400
	0605	45 ×10	SS 720	2300	760	2500
	0606	55 ×10	SS 720	2300	760	2600
	0607	65 ×10	SS 720	2300	760	2700
SSP-700 GS	0701	22 ×16	SS 450	2350	860	2600
	0702	30 ×16	SS 450	2350	860	2600
	0703	37 ×16	SS 450	2350	860	2700
	0704	45 ×14	SS 514	2350	860	2700
	0705	55 ×14	SS 514	2350	860	2800
	0706	65 ×12	SS 600	2350	860	2800
	0707	75 ×12	SS 600	2350	860	2900
	0708	90 ×12	SS 600	3100	860	2900
SSP-800 GS	0801	30 × G	350	2250	960	2000
	0802	37 × G	350	2350	960	2100
	0803	45 × G	350	2350	960	2200
	0804	55 × G	350	2350	960	2200
	0805	65 × G	350	2650	960	2500
	0806	75 × G	400	2650	960	2500
	0807	90 × G	400	2900	960	2900
	0808	110 × G	400	2900	960	2900
	0809	90 ×16	SS 450	3600	960	5000
	0810	110 ×16	SS 450	3600	960	5000

Models	No.	Motor Output x No. of Poles	Speed	A (mm)	φ B	Mass (kg)
SSP-900 GS	0901	37×G	300	2450	1060	2500
	0902	45×G	300	2450	1060	2600
	0903	55×G	300	2450	1060	2600
	0904	65×G	300	2700	1060	2900
	0905	75×G	300	2700	1060	2900
	0906	90×G	350	3100	1060	3200
	0907	110×G	350	3100	1060	3300
	0908	132×G	350	3300	1060	3400
	0909	110×G	400	3100	1060	3300
	0910	132×G	400	3300	1060	3400
SSP-1000 GS	1001	37×G	250	2500	1160	2900
	1002	45×G	250	2500	1160	3000
	1003	55×G	250	2500	1160	3100
	1004	65×G	250	2800	1160	3300
	1005	65×G	300	2800	1160	3200
	1006	75×G	300	2800	1160	3300
	1007	90×G	300	3100	1160	3600
	1008	110×G	300	3300	1160	3800
	1009	132×G	350	3300	1160	3900
	1010	150×G	350	3300	1160	3900
	1011	175×G	350	3300	1160	4000
SSP-1200 GS	1201	55×G	200	2800	1350	4100
	1202	65×G	200	3300	1350	4700
	1203	75×G	200	3300	1350	4700
	1204	90×G	200	3300	1350	4800
	1205	90×G	250	3300	1350	4900
	1206	110×G	250	3300	1350	5000
	1207	132×G	250	3300	1350	5000
	1208	175×G	250	3550	1350	5100
	1209	175×G	300	3400	1350	5000
	1210	220×G	300	3550	1350	5200
SSP-1350 GS	1401	65×G	175	3500	1500	5600
	1402	75×G	175	3500	1500	5600
	1403	90×G	175	3500	1500	5700
	1404	110×G	175	3500	1500	5700
	1405	110×G	225	3500	1500	5700
	1406	132×G	225	3600	1500	5800
	1407	150×G	225	3500	1500	5800
	1408	175×G	225	3600	1500	5900
	1409	220×G	225	3600	1500	6000
	1410	220×G	275	3600	1500	6000
	1411	250×G	275	4100	1500	6500
SSP-1500 GS	1501	90×G	175	3600	1650	6600
	1502	110×G	175	3800	1650	6900
	1503	132×G	175	3800	1650	6900
	1504	150×G	175	3800	1650	6900
	1505	175×G	175	3800	1650	7000
	1506	220×G	225	3800	1650	6900
	1507	250×G	225	3800	1650	7000

Архангельск (8182)63-90-72
Астана (7172)727-132
Астрахань (8512)99-46-04
Барнаул (3852)73-04-60
Белгород (4722)40-23-64
Брянск (4832)59-03-52
Владивосток (423)249-28-31
Волгоград (844)278-03-48
Вологда (8172)26-41-59
Воронеж (473)204-51-73
Екатеринбург (343)384-55-89
Иваново (4932)77-34-06

Ижевск (3412)26-03-58
Иркутск (395)279-98-46
Казань (843)206-01-48
Калининград (4012)72-03-81
Калуга (4842)92-23-67
Кемерово (3842)65-04-62
Киров (8332)68-02-04
Краснодар (861)203-40-90
Красноярск (391)204-63-61
Курск (4712)77-13-04
Липецк (4742)52-20-81
Киргизия (996)312-96-26-47

Магнитогорск (3519)55-03-13
Москва (495)268-04-70
Мурманск (8152)59-64-93
Набережные Челны (8552)20-53-41
Нижний Новгород (831)429-08-12
Новокузнецк (3843)20-46-81
Новосибирск (383)227-86-73
Омск (3812)21-46-40
Орел (4862)44-53-42
Оренбург (3532)37-68-04
Пенза (8412)22-31-16
Казахстан (772)734-952-31

Пермь (342)205-81-47
Ростов-на-Дону (863)308-18-15
Рязань (4912)46-61-64
Самара (846)206-03-16
Санкт-Петербург (812)309-46-40
Саратов (845)249-38-78
Севастополь (8692)22-31-93
Симферополь (3652)67-13-56
Смоленск (4812)29-41-54
Сочи (862)225-72-31
Ставрополь (8652)20-65-13
Таджикистан (992)427-82-92-69

Сургут (3462)77-98-35
Тверь (4822)63-31-35
Томск (3822)98-41-53
Тула (4872)74-02-29
Тюмень (3452)66-21-18
Ульяновск (8422)24-23-59
Уфа (347)229-48-12
Хабаровск (4212)92-98-04
Челябинск (351)202-03-61
Череповец (8202)49-02-64
Ярославль (4852)69-52-93